

Trace the letter "H h" with finger and colour the picture.

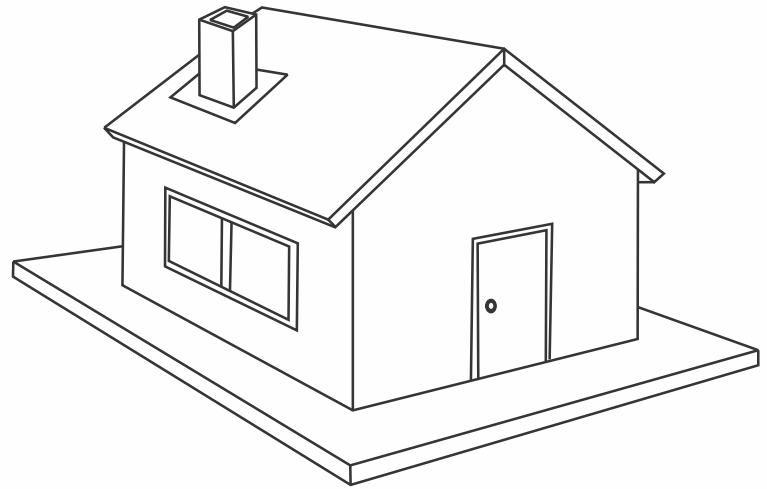
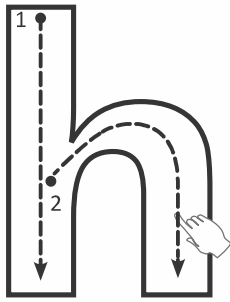
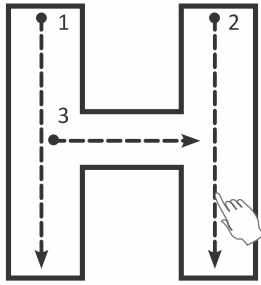

**HOUSE**

**house**

Trace the letter "H h".

Tracing practice area for the letter 'H'. It consists of six rows of handwriting lines. Each row starts with a solid uppercase 'H' followed by seven dashed uppercase 'H's for tracing. The first row is followed by five rows of dashed uppercase 'H's for independent practice.

H H H H H H H

h h h h h h h

h h h h h h h

h | h h h h h h h

h h h h h h h

h h h h h h h

h h h h h h h

h h h h h h h

h h h h h h h

h h h h h h h

h h h h h h h

H H H H H H H

.

.

h h h h h h h

.

.

.

.

.

.

.

# ACTIVITY

Write the correct beginning letter in each box.

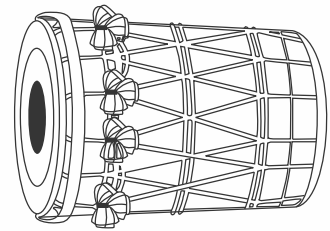
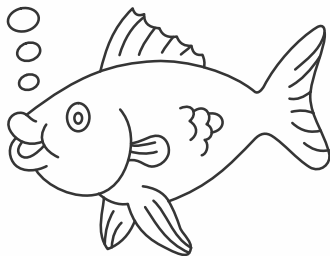
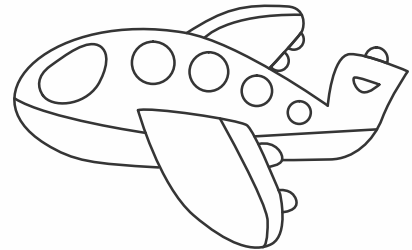
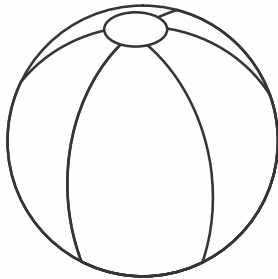
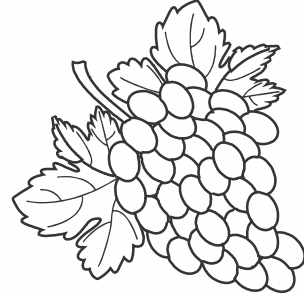
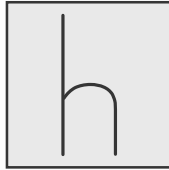
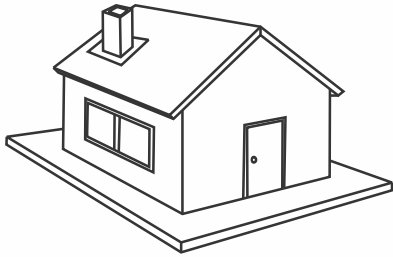

Colour the pictures that begin with h.

